

Application Checklist

Before submitting your required application, please confirm you have the following items:

- Completed Application Form, which includes the following:
 - ☐ Owner's Name and Mailing address/contact information
 - ☐ Current Status of Title
Inground Pools Only
(dated within 30 days of application)
 - ☐ Proof of Ownership
Above Ground Pools and Hot Tubs
(may be required)
 - ☐ Tax Roll Number /Civic Address and/or Legal Description
 - ☐ Letter of Authorization
 - ☐ Site Plan
 - ☐ Plan Review Fee
 - ☐ Construction drawings
Engineer's seal required for inground pools
(Maximum paper size 11"x17")

Do I require any other permits or approvals?

- Developer's approval may be required dependant on the area of construction.
- Manitoba Department of Infrastructure and Transportation approval is required if any structure or use is located within a highway control corridor or intersection circle; and, for any planting within 50 feet of a Provincial Road or Highway Right-of-Way.
- A Geotechnical Report will be required when construction occurs within 350 feet of the Red River, Lake Winnipeg, or a tributary.
- Other permits or approvals may be required. Please discuss your proposal with RRPD staff for more information.

Don't forget to call before you dig:



Manitoba Hydro 1-888-624-9376
MTS (204) 941-7267
Shaw 1-866-344-7429

WEB: www.callb4udig.mb.ca

All fees and information are subject to change without notice, and should be verified by the Red River Planning District Office.

RED RIVER PLANNING DISTRICT

2978 BIRDS HILL ROAD
EAST ST. PAUL, MB, R2E 1J5
PH: (204)669-8880 FAX: (204) 669-8882
TOLL FREE: 1-800-876-5831

Method of payment: Cash, debit or cheque,
payable to Red River Planning District.

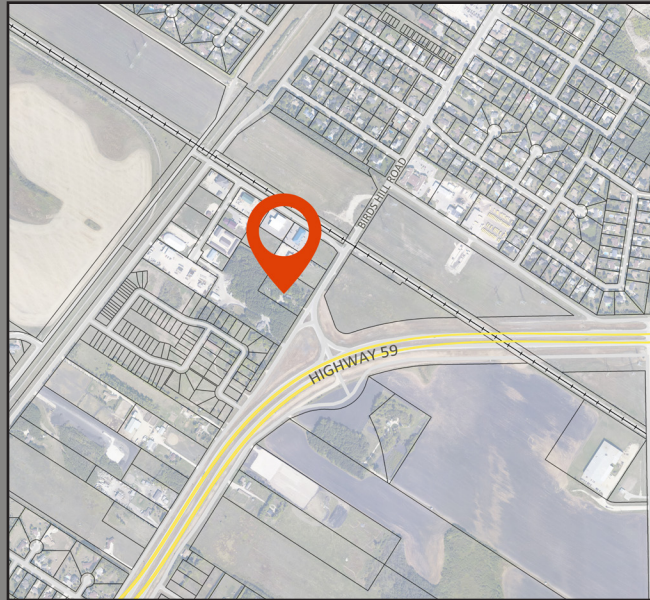

E-MAIL: info@rrpd.ca

WEBSITE: www.redriverplanning.com

ONLINE PERMIT APPLICATIONS

<https://ca.cloudpermit.com/login>

Cloudpermit

This Pamphlet provides general guidance only. For definitive requirements and procedures, please consult *The Planning Act*, the National Building Code, the Development Plan, the respective Secondary Plan, Zoning By-Law, Building By-Law and/or any other applicable By-Law, Agreement, or other piece of applicable legislation.

Please contact the Red River Planning District for further information or to make an application.

Date Revised: November 1, 2022

POOLS AND HOT TUBS



RED RIVER PLANNING DISTRICT

Guiding Development • Building Community

Planning and Development Services
St. Clements • St. Andrews
East St. Paul • West St. Paul • Dunnottar

Is a building permit required to place or construct a pool or hot-tub?

YES. Whether it is a hot-tub or the pool is seasonal, inground or above ground, if the depth is greater than 600 mm (2 feet), a Pool Permit is required.

What is required to apply for a Pool Permit?

- Site Plan which shows all property lines and dimensions with setbacks to the proposed pool from all sides. As well, all existing structures, with setbacks to the nearest existing structure;
- Location of pool equipment on the property;
- Plans of the pool including diameter, depth and how the pool will be enclosed to comply with Part 10 of the Manitoba Building Code. (Minimum 5 ft. high barrier with all openings to be self-closing and lockable)
- Current Status of Title (dated within 30 days of application date)
- Residential Plan Review Fee

To determine required setbacks you must provide us with a tax roll number and/or a proper legal description and the municipality or city in which you are building in order for our office to determine your zoning. A legal survey, or building location certificate, may be requested, and will provide you with your exact lot size.

What type of fence will I require?

Outdoor pools must be enclosed with a fence or other suitable barrier constructed in accordance with Section 10.1.2 of the *Manitoba Building Code (Regulation 127/2006)*. (Minimum 5 ft. high barrier with all openings to be self-closing and lockable)

Fences must be completely enclosed by a vertical board fence, with no vertical or horizontal supports that would facilitate climbing, or a chain link fence not less than No. 12 gauge galvanized steel wire, constructed or erected in accordance with the following:

- Fences shall have a minimum height of 5.0 feet (1.52m), including gates.
- There shall be no openings other than an entry to a building or a gate and it shall be constructed so as to prevent a child from crawling under either the fence or gate.
- Gates must be self-closing and equipped with a lockable latch.

A fence is not required for a hot-tub, as long as the hot-tub is equipped with a lockable cover, as per Section 10.1.2.3 of the *Manitoba Building Code (Regulation 127/2006)*.

TYPICAL SITE PLAN

